



AIR200G & AIR400G

Air Supply

User Manual

TABLE OF CONTENTS

Symbol References.....	2
Intended Use and Precautions.....	2
Part Identification.....	3
Product Specifications.....	3
Cleaning and Preventive Maintenance.....	4
Returns and Repairs.....	4

AIR200G & AIR400G User Manual

Symbol Reference



REFER TO MANUAL



THIS END UP



TYPE BF APPLIED PART



TEMPERATURE LIMITATION



ALTERNATING CURRENT



HUMIDITY LIMITATION



MANUFACTURER



DATE OF MANUFACTURE



GENERAL WARNING SIGN



KEEP DRY

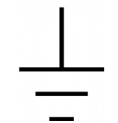

FUNCTIONAL EARTH (GROUND)



CAUTION



CSA C22.2 No. 601.1, UL-60601-1

Intended Use and Precautions

The Air200G and Air400G are single-speed air supplies used to inflate HoverTech's HoverMatt® Air Transfer Mattresses and HoverJack® Air Patient Lifts.

INTENDED USE

- The caregiver/operator is the person handling the equipment.
- The patient is not the intended operator.

CAUTIONS

- Route the power cord in a manner to ensure freedom from hazard.
- Avoid blocking the air intakes of the air supply.
- Never leave patient unattended on an inflated device.

- Use this product only for its intended purpose as described in this manual. Only use attachments and/or accessories that are authorized by HoverTech International.
- When using the air supply in the MRI environment, a 25 ft. specialty MRI hose is required (available for purchase).
- Avoid electric shock. Do not open air supply.
- Reference product-specific user manuals for additional operating instructions.
- Warning: To avoid the risk of electric shock, this equipment must only be connected to a supply main with protective earth.

INTENDED CARE SETTINGS

Hospitals, long-term or extended care facilities and ambulance/transport.

AIR200G & AIR400G User Manual

Part Identification

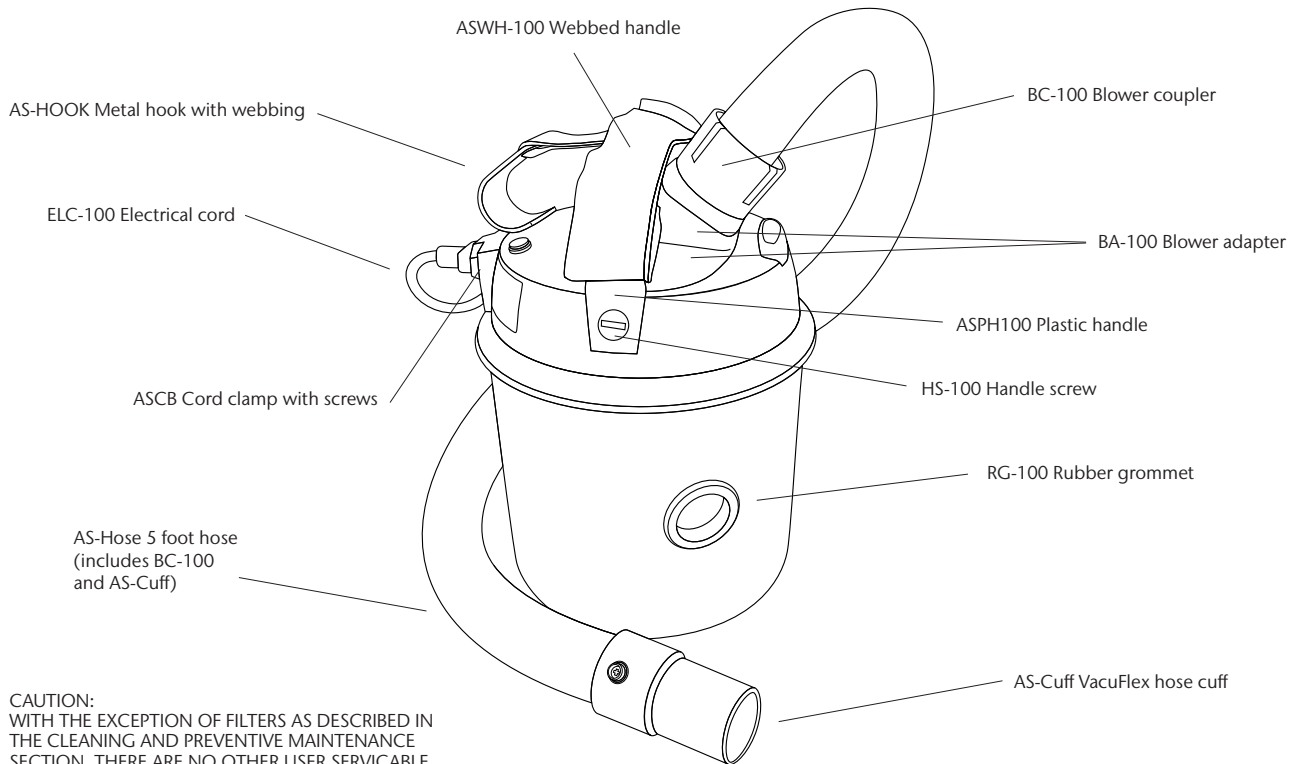

CAUTION:
WITH THE EXCEPTION OF FILTERS AS DESCRIBED IN
THE CLEANING AND PREVENTIVE MAINTENANCE
SECTION, THERE ARE NO OTHER USER SERVICABLE
PARTS.

Product Specifications

Dimensions:	9 DIA x 16 H inches (22.8 cm x 40.6 cm)
Weight:	11 lbs. (5 kg)
Material:	Lexan/Stainless Steel
Power Cord Length:	15 feet (457 cm)
Type:	SJT 16 AWG*3C
Service Life:	5 years
Power Input:	120 V~, 60 Hz, 10 A

Model #Air200G – 800W

Model #Air400G – 1100W

LATEX FREE

CLASSIFICATION

Not for use in the presence of flammable anesthetics or in a hyperbaric chamber or oxygen tent.

Type of protection against electric shock:	CLASS I EQUIPMENT
Degree of protection against electric shock:	TYPE BF APPLIED PART
Protection against ingress of water:	Ordinary (not protected).
Mode of operation:	CONTINUOUS OPERATION
To remove supply mains, unplug equipment from wall.	
Use Temperature:	50° to 104° F (10° to 40° C)
Use Humidity:	10% to 70% Non-Condensing
Storage/Shipping Temperature:	-40° to 176° F (-40° to 80° C)
Storage/Shipping Humidity:	10% to 70% Non-Condensing

AIR200G & AIR400G User Manual

Cleaning

Between patient use, clean and disinfect the surface of the air supply by wiping it down with EPA approved hospital-grade disinfectant wipes or disinfectant cleaner sprayed on a cleaning cloth. Follow disinfectant manufacturer's directions for dwell time and other instructions for use.

NOTE: DO NOT SPRAY CLEANERS/LIQUIDS DIRECTLY ON THE AIR SUPPLY.

PREVENTIVE MAINTENANCE

Prior to use, a visual inspection should be performed on the air supply to ensure the power cord is not frayed or nicked and that there is no visual damage that would render the air supply unusable.

If any damage is found that would cause the air supply not to function as intended, the air supply should be removed from use and returned to HoverTech International for repair.

The air supply has an air filter over the motor housing. This filter can be accessed by removing the three small screws holding the canister to the motor. It is recommended that the air filter is assessed per your facility's preventive maintenance schedule or annually. Filter should be cleaned if visibly dirty. Remove the filter from the air supply and hold it under warm

running water. Allow the air filter to dry prior to placing back in the air supply.

The filter should be replaced when it is clogged with debris that does not break free when it is washed. The filter should also be replaced if it begins to lose its shape or deteriorate.



NOTE: IF AIR SUPPLY NEEDS TO BE DISPOSED, CHECK YOUR LOCAL / STATE / FEDERAL / INTERNATIONAL GUIDELINES BEFORE DISPOSAL.

INFECTION CONTROL

When a HoverTech air supply is used in a patient room where isolation protocols are being observed, the hospital should employ the same protocols/procedures it utilizes for other equipment used in that patient room.

Between use with an airborne isolation patient, the air supply filter can be removed and disinfected or replaced if hospital protocol requires. If the air filter is disinfected, allow it to dry prior to placing back in the air supply.

An air hose cover is available. These covers are disposable and come in a box of 25 (Model #ASHC).

Returns and Repairs

All products being returned to HoverTech International (HTI) must have a Return Goods Authorization (RGA) number issued by the company. Please call 800-471-2776 and ask for a member of the RGA Team, who will issue you an RGA number. Any product returned without an RGA number will cause a delay in the repair time.

Returned products should be sent to:

HoverTech International
Attn: RGA # _____
4482 Innovation Way
Allentown, PA 18109



4482 Innovation Way
Allentown, PA 18109

800.471.2776
Fax 610.694.9601

www.HoverMatt.com
Info@HoverMatt.com